

**RiZO**  
RiZO - Lighting & Solution



Company profile

Company history

R&D System and Products design

Product system

Marketing system

Lighting experience centers

Lighting design

Exhibition calendar

Project case

KSTE Partner

Honor and qualification





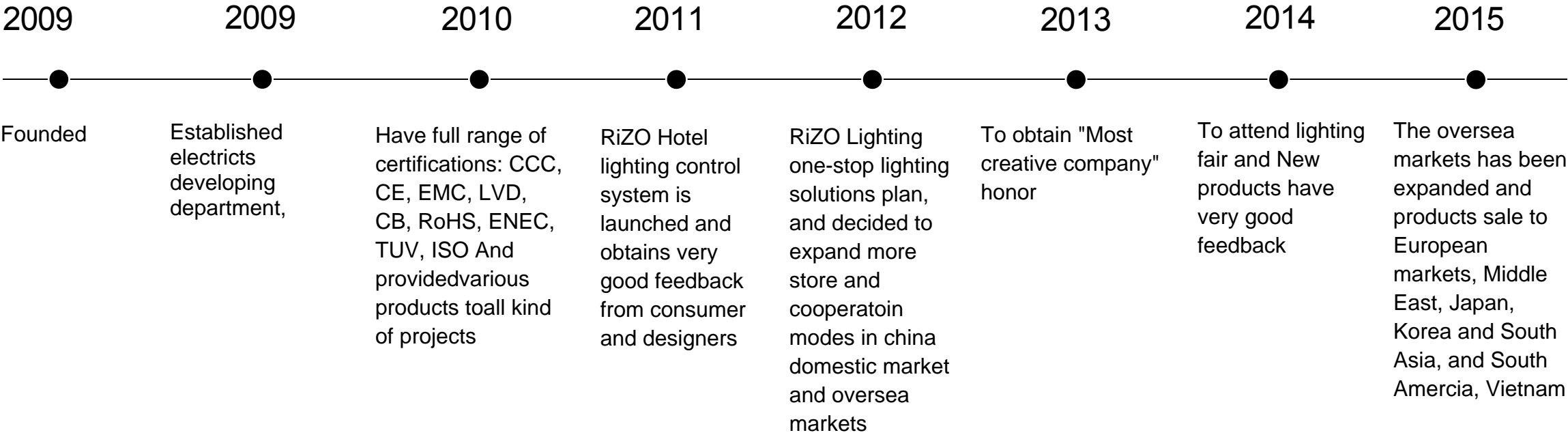



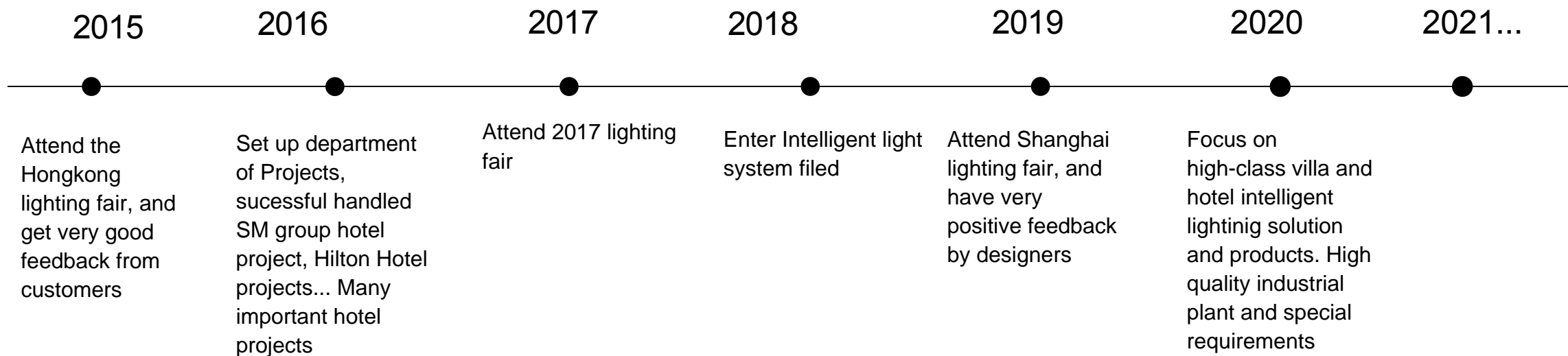



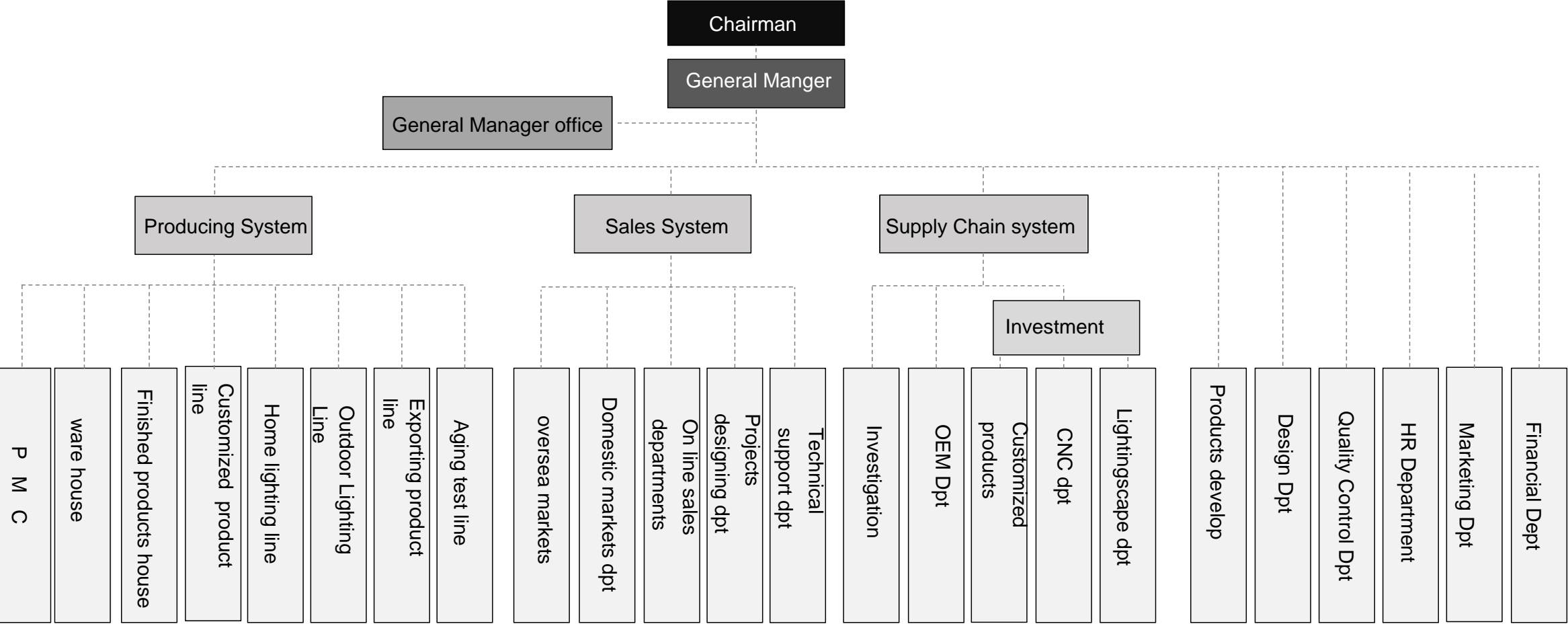





## Brand Position

High-Class Intelligent  
Commercial Lighting  
Solution provider



## Brand Advantage

- 15 years + experience in commercial lighting developing and manufacturing
- All aspects of lighting products supplying for all kind of commercial products
- Strong support team for projects of lighting solution.
- All kind of licences and certifications



## Brand Vision

To be a leading commercial lighting brand and to provide excellent products and services for the customers from the worldwide.





Unite, strive, innovate and be realistic

### Core concept

Improve self,  
pursue excellence,  
cooperate with each other  
share win-win

### Management Concept

Honesty based,  
service foremost,  
excellence,  
innovation and  
development

### Win-Win Cooperation

Honesty, dedication,  
pragmatism,  
innovation, unity,  
gratitude, cooperation  
and win-win



High-end commercial lighting advocates brand

National bidding AAA credit enterprise

National High Tech Enterprises

Qualified Company for Exporting

Famous brands in China

AAA enterprise of abiding by contract and  
keeping promise

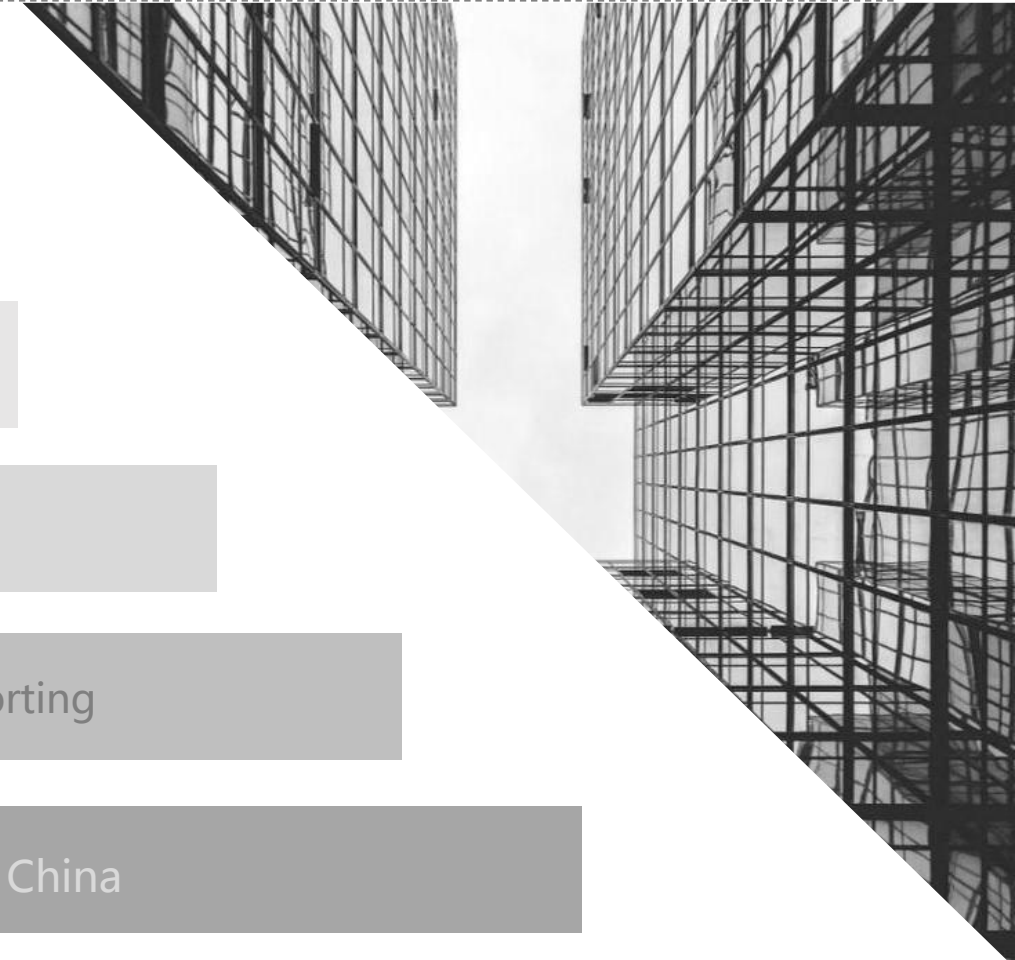



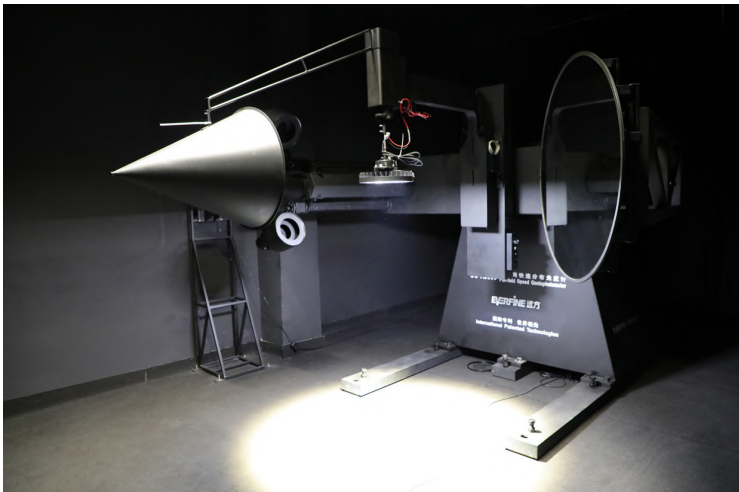
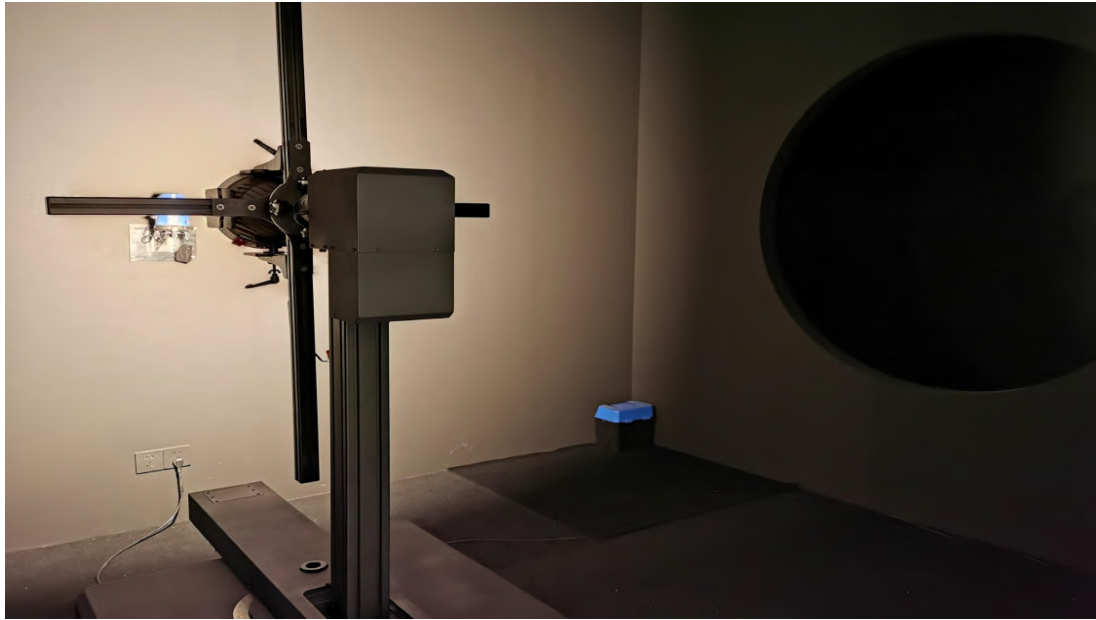













• R&D office



• 100% Aging test before shipment



• Packing Line



• Aging testing



• Test

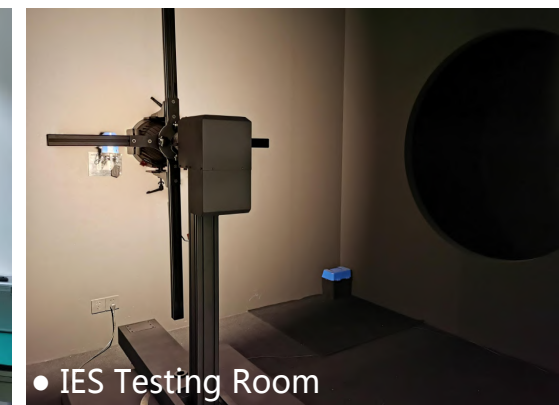

• IES Testing Room



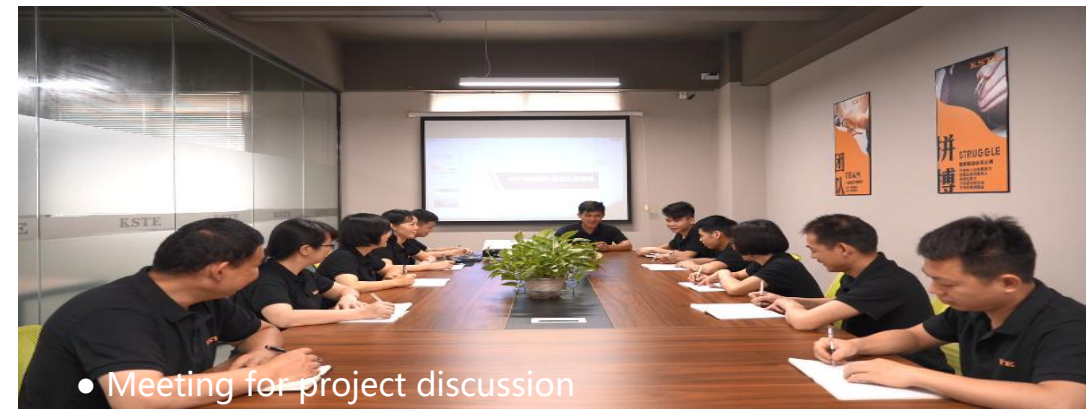
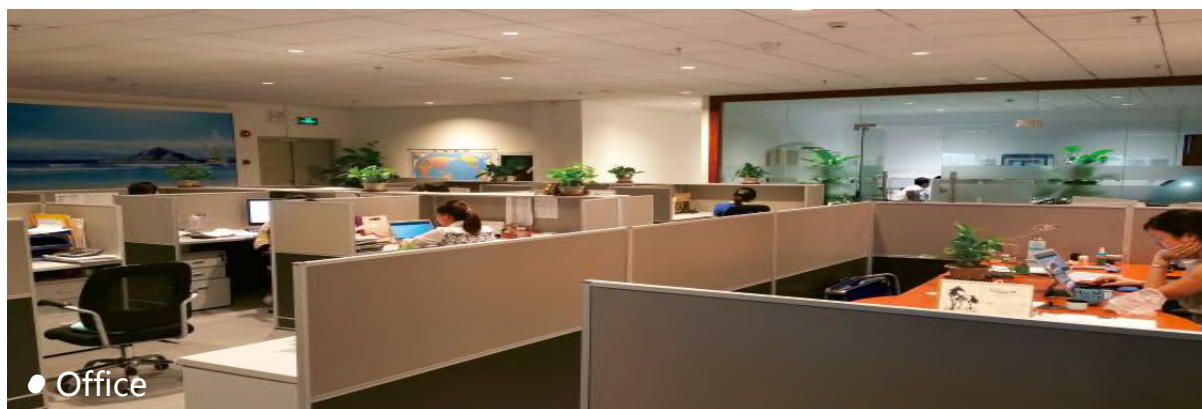



RiZO lighting have various products lines with unique design, multi-functional, excellent performance including commercial lighting, hotel lighting, office lighting, outdoor lighting, factory lighting, and Intelligent system, etc

### HOTEL LIGHTING

As a professional manufacturer for hotel lighting, RiZO Lighting provide thoughtful products solution for more than thousand of five star hotel. according each demands to provide the most proper products

### FACTORY LIGHTING

Our products meet almost all factories with the most demanding requirements of customers. Smart warehouse applications and special projects.

### COMMERCIAL LIGHTING

RiZO commercial lighting with thoughtful design, and lighting performance

### OFFICE LIGHTING

RiZO Lighting beloved by office lighting, building lighting, and public lighting due to the superious quality.

### OUTDOOR LIGHTING

Energy saving and special design and wonderful lighting effect, these advantages to help RiZO outdoor lighting being popular.

### ELECTRICAL PRODUCTS

To provide Power supply, and related lighting control system

### REAL ESTATE LIGHTING

RiZO Lighting have wide using to many famous real estate.

### MUSEUM LIGHTING

With high-quality lighting effect, can vivid and high quality, and vivid to show the museum texture.



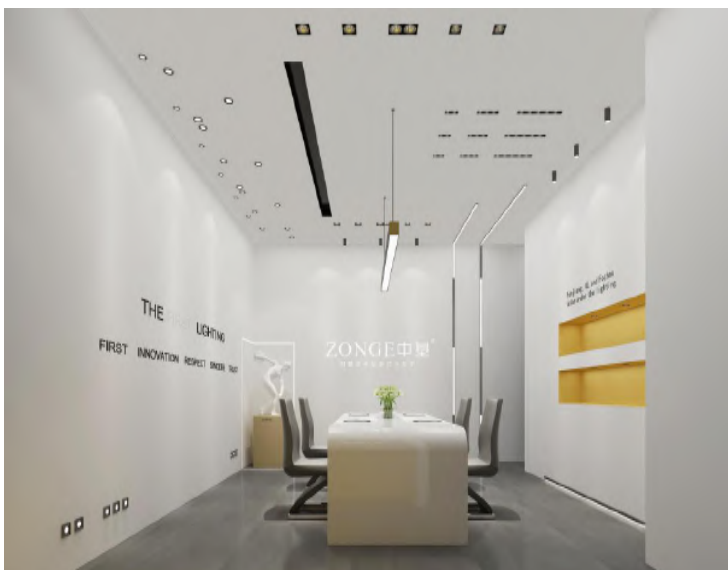



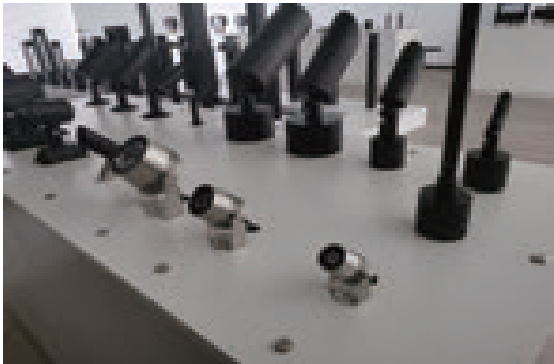





After more than 15 years experiences and continuous invest, RiZO Lighting had built a mature developing system, and provide a strong support for RiZO Lighting's growing, and we have set up R&D center in both china and Italy, and have senior engineering team, to bring the new and multi-function and unique products to our customer.

Along with the technology developing and the living level has been improved a lot as well. So people will persuit a relax, comfortable and health lighting envirements. A advanced test equipment and test roomi is a strong guarantee to good quality.

We are always looking for new advanced components and technologies, both for the designing of new luminaires and the upgrading of the already-existing fixtures. Every single element and material isscrutinized in order to guarantee the best design solution interms of aesthetic value, function-ality, andefficiency.







## Exporing Drawing

- 1 TRIM: Aluminum materials, with D55mm, D75mm, D95mm hole cut for option
- 2 Heat-Sink: With high-pure die-casting aluminum , with excellent heat radiation to ensure the long life time
- 3 Light Source Holder- With fireproof materials and heat-resistance ABS materials
- 4 Lens- With High accurate PC materials, with 15/24/36/55D beam angle for option
- 5 Lower joinion ring
- 6 Middle Ring: With top quality ABS plastic materials Middle ring, to ensure good flixible adjustment angle.
- 7 Loop: Just need to pull off the loop and then could take off the whole heat-sink, to acheive easy replacement.
- 8 Reflector: With High-quality plastic reflector, and to meet different option: Gun-Black/ Mirror Silver / Matt-Black / Matt-White

## Efficiency

- A new design with high-lumen efficiency structure, output lumen efficiency can reach 120lm/W
- Detachable module design, can freely exchanged module to meet various demand for waterpooof and lumen-efficiency
- Colorfull reflector painting option

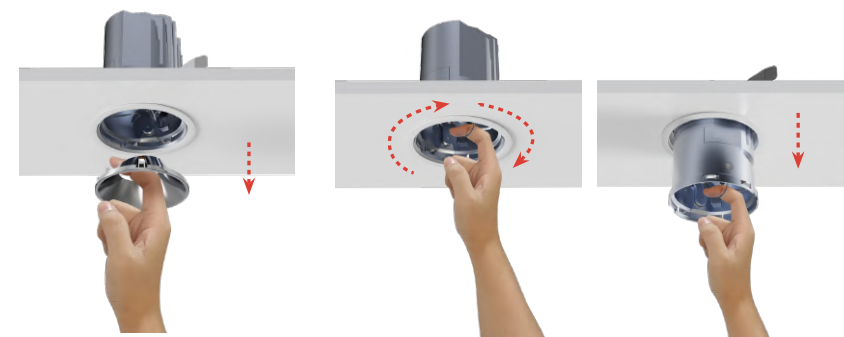

1  
Take out reflector cover

2  
Rotatable adjustment

3  
Pull out the module



### Lighting Technology

## Colorful light mixed color

Accurate light output without dots.

Small and compact body but with high power.

Uniformity of color mixing, high saturation without any color layering. New anti glare technology, 0.2 meter anti glare.





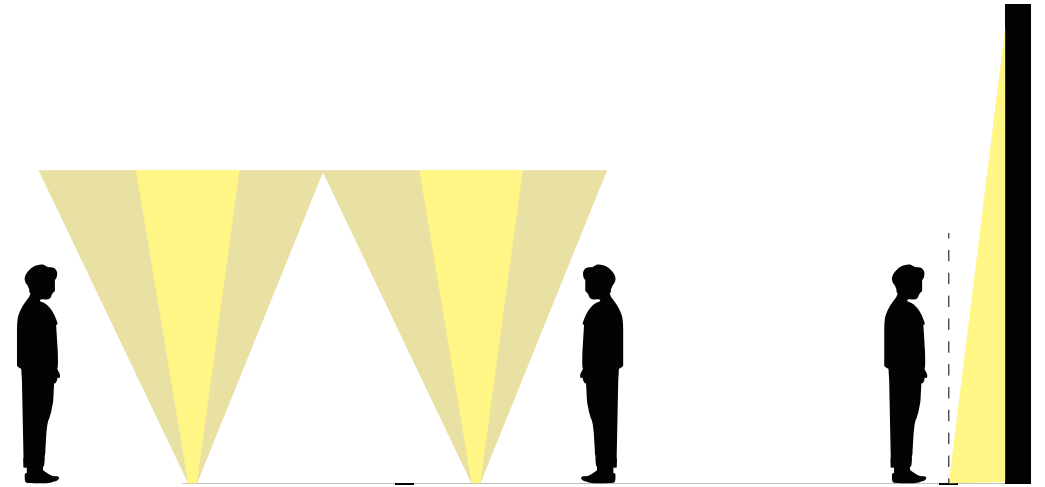

Lighting Technology

## Ultradim Optics

Ultra-short anti glare distance = 0.1M

Ultra wide and high-precision light distribution

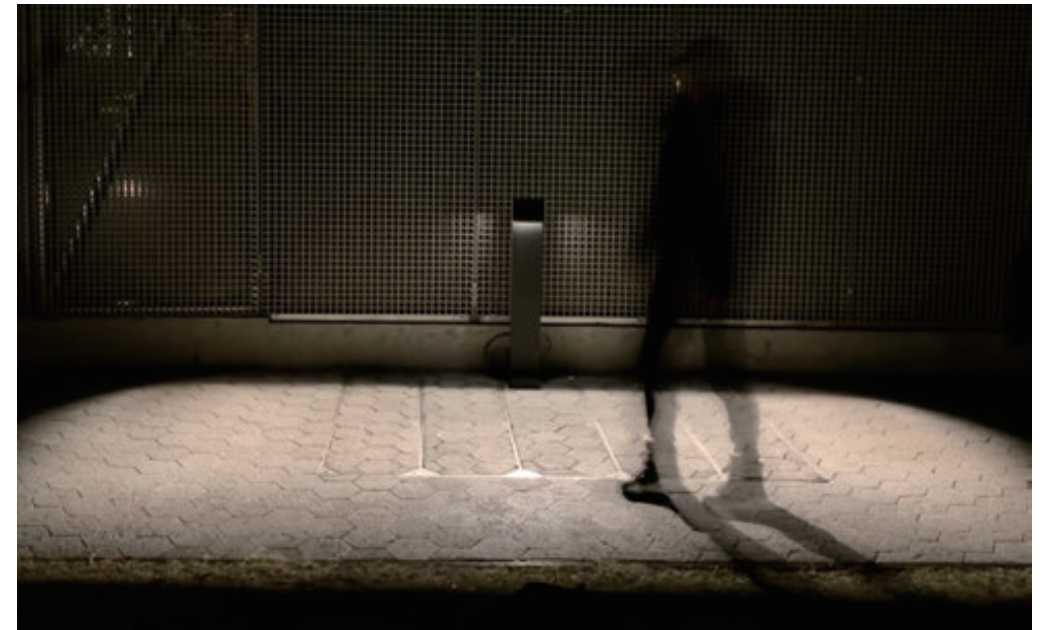



Lighting Technology

## Convective Ventilation

Increase heat dissipation efficiency by 20%

Reduce heat dissipation area, save cost

Using the principle of convection of hot&cold air, and the pressure difference caused by specially designed small space, to make air flow faster to get better effect of heat dissipation.

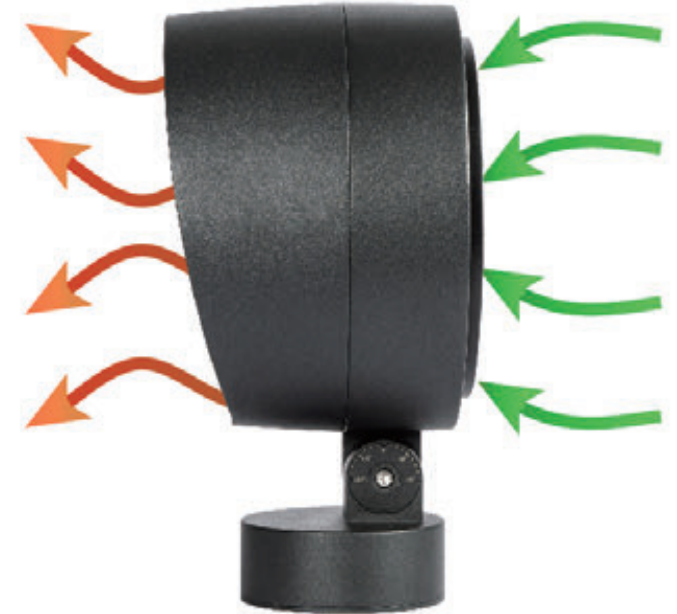
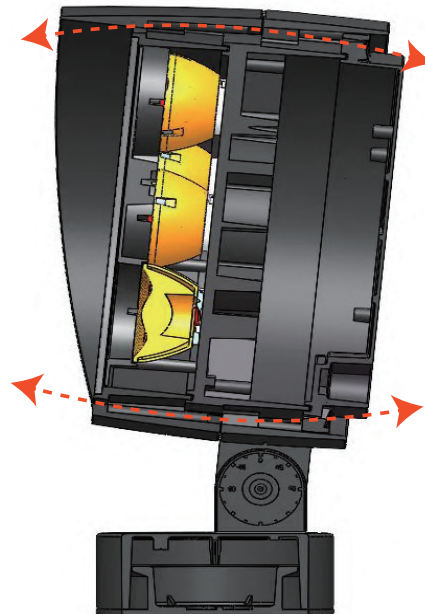



Lighting Technolog

## **Water&gas - prevented**

Solve condensation caused by negative pressure The

condensation-prevented joint and cable are

integrated, with a beautiful and simple appearance

Recyclable energy-saving standards

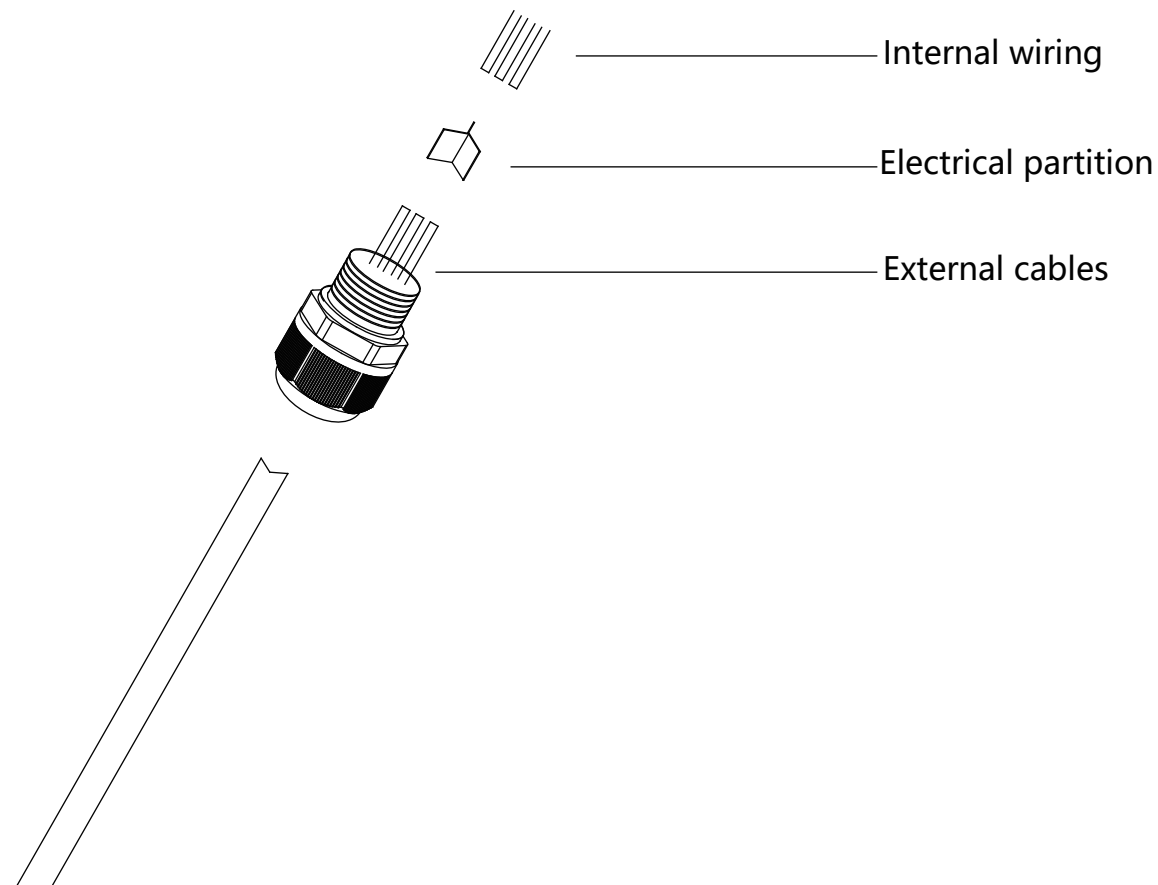



## SUSTAINABILITY

- Super-high Light Efficiency
- Beam Design to Limit Light Loss
- Intelligent Lighting
- Replaced Lighting Source
- DIY Components
- Solar light solution
- Plastic Free Package
- Recyclable Raw Materials
- Less Maintenance and More Longevity





### SUSTAINABILITY

#### Humanity & Nature

RiZO has been conducting years of research and design on optics for anti glaring safety of the human eye, ensuring that we protect the human eye in a reasonable environment. We can provide low color temperature (including low blue light) products with dimming options to avoid disrupting the natural survival of animals and plants.

#### Modularity

Modular design of internal accessories for easy maintenance, replacement, and production.

#### Repairable

Can provide 15 years of product maintenance services. Improve product upgrade and replacement plans without the need to replace lighting fixtures.

#### Material Energy

Improve process efficiency, avoid waste and consumption, and choose renewable materials.

#### Photoeffect

Enhanced luminous efficiency of products and usage efficiency of scene applications.



Light Touch



1800K-5000K

To protect nocturnal animals, we can provide 1800K-3000K tunable white dimming function. RiZO can also provide product with low CCT (less blue CCT) to protect plants to grow naturally. Can also reduce power and save energy when tune it to amber CCT.



RiZO has been researching and designing anti-glaring for many years, aiming to protect our eyes in different environments.

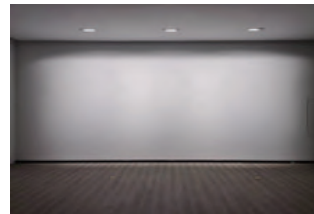

Using optical design to improve product lighting efficiency and usage rate, can reduce product qty in some certain areas, saving energy.



Can provide 15 years product maintenance service. Can provide product upgrade solution without replacing fixture.



Some of RiZO products use bamboo steel as accessories, high intensity, high tenacity, corrosion resistance and reproducible. Bamboo steel is a kind of materials of recombinational with high technology, can promote green development. Bamboo steel can be also used to replace wood and plastic.



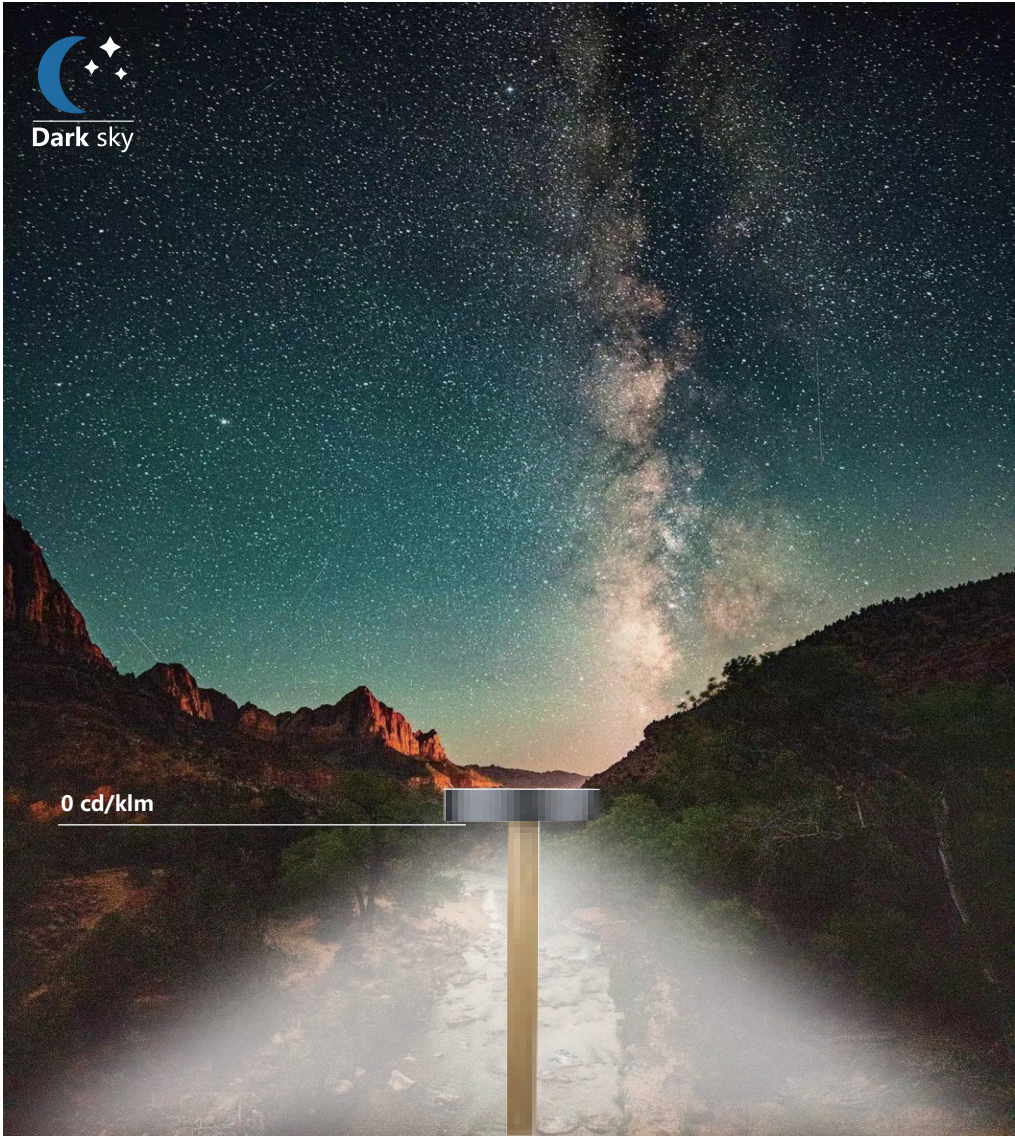

The luminaire from RiZO "Dark Sky" series throws it's light with high efficiency to the illuminated area, and emits less than 1% to theupper space of the luminaire.

The exact data regarding the percentage of luminous flux in the upper half-space, as well as statements on the BUG rating according to IES TM-15-07 and the CEN Flux Code in compliance with EN 13032-2 can be found in the product data sheets for the various luminaires onthe RiZO website, and must be checked against regionally applicable regulations.



**BUG Rating:B2—U0—G1**

**Forward Light**

Zone	Luminaire %
FL—Front—Low (0-30°)	15.5
FL—Front—Medium (30-60°)	28.1
FL—Front—High (60-80°)	6.9
FL—Front—Very High (80-90°)	0.5

**Back Light**

Zone	Luminaire %
BL—Back—Low (0-30°)	16.4
BL—Back—Medium (30-60°)	28.5
BL—Back—High (60-80°)	5.8
BL—Back—Very High (80-90°)	0.4

**Up Light**

Zone	Luminaire %
UL—Up light—Low (90-100°)	0
FL—Up light—High (100-180°)	0

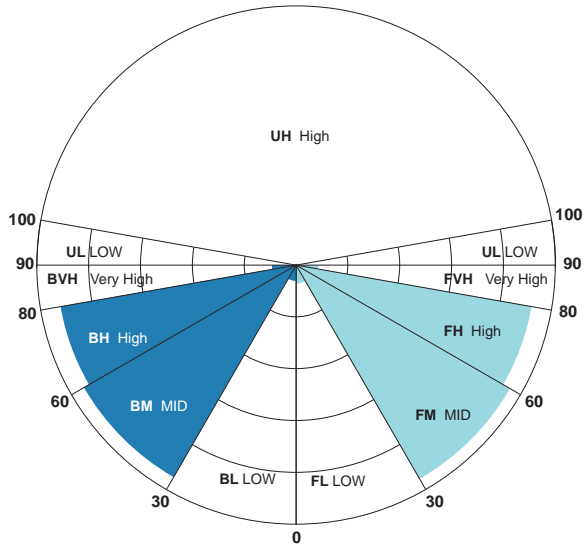



### Air convection

The constant power recently in market is achieved by two solutions mostly:

1. By later controller. For example, the luminaire is requested constant 18W RGBW, in fact, to get monochrome color with 18W, the luminaire must be 72W, and then to get constant power by controlling system, in this case, the main power supply must be calculated basing on 72W, increasing budget of project..
2. By software. But the instant starting current will be too high, so the main power supply must be calculated basing on 72W too, otherwise, the luminaire can't work normally. RiZO product, uses a unique patented design - software + preset hardware, to get constant power, before SCM finishing initialization, output current will be controlled by preset hardware, after finishing initialization, SCM gives signal to hardware to get power turned synchronously.

### Grayscale (Brightness)

The constant power achieved through the later software must sacrifice the grayscale of the luminaire, for example, 72W RGBW floodlight, about 18W each color, to get three color mixing, the power of each color must be lower to get 18W. Controller transmits signal to decoder of luminaire, decoder turn on and off quickly to reduce power, thus luminaire's grayscale is not full.

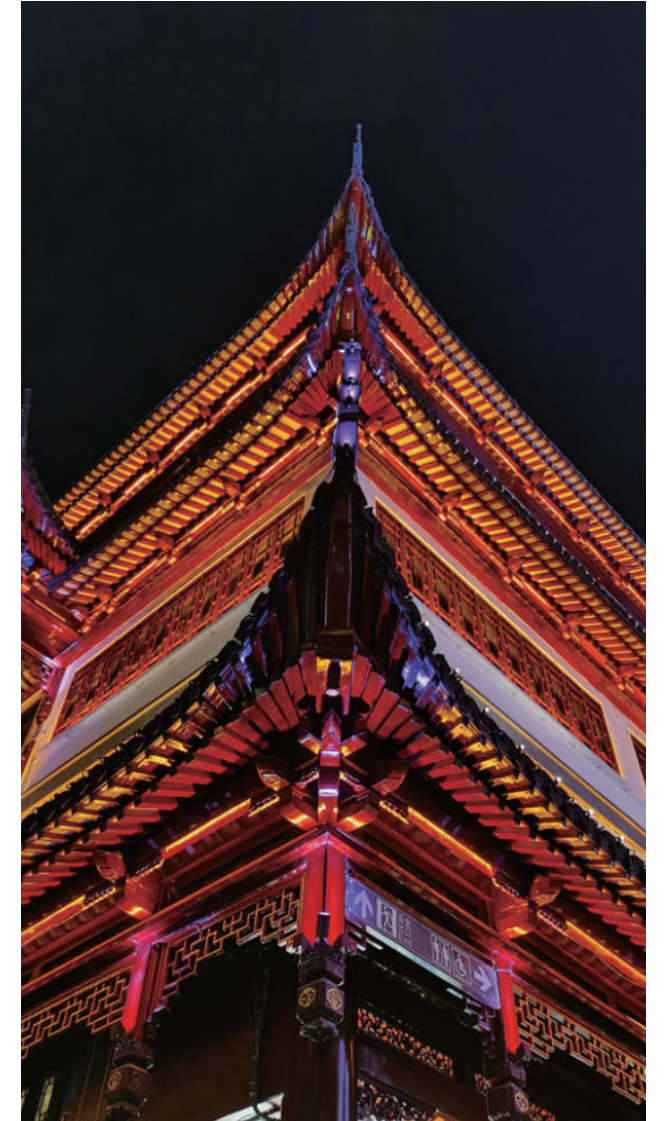



## Lighting Efficiency

For the lighting performance, we mainly focus on the luminaire's flux, but not specification of the light output lumen ratio of the products in the scene.

RiZO outdoor lighting focuses on optical research technology, when we select optical parts, we care more about usage of optics in different scenes, try to make lighting efficiency 100%, so we've developed a series of technologies that use secondary optical reflection, making lighting to throw more widely, in this case, one lighting fitting can replace two or even four products. In a sense, we can achieve another kind of optical energy-saving effect.

To get higher lighting distribution and less glaring, we use secondary reflection with going down distribution in different applications, providing visual safety lighting.







On site Support



Lighting Calculation  
DIALux evo



Mock up testing



Customization



The lighting design is to provide the most proper lighting, to achieve the most comfortable and relax lighting environment. RiZO lighting design team provide the professional suggestion, and can provide the customized lighting solution for every customer, and the installation and adjusting service.

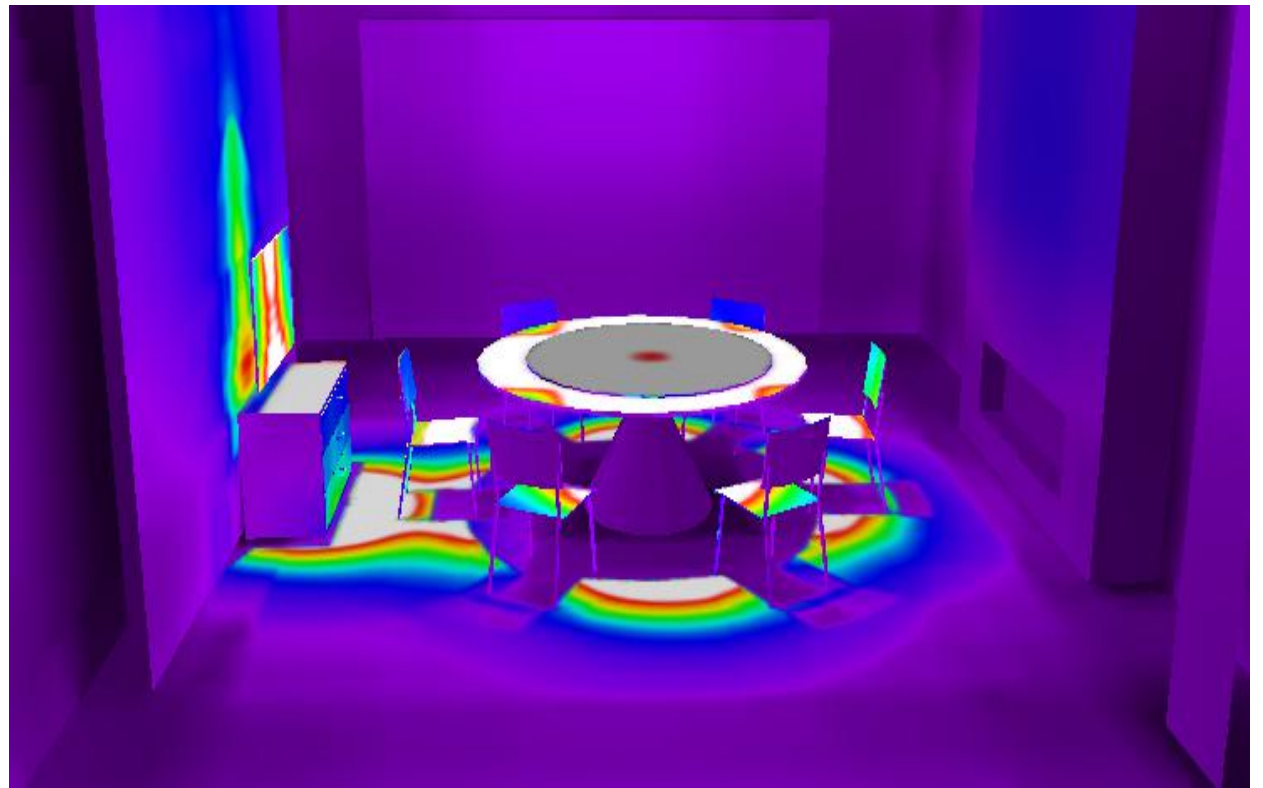



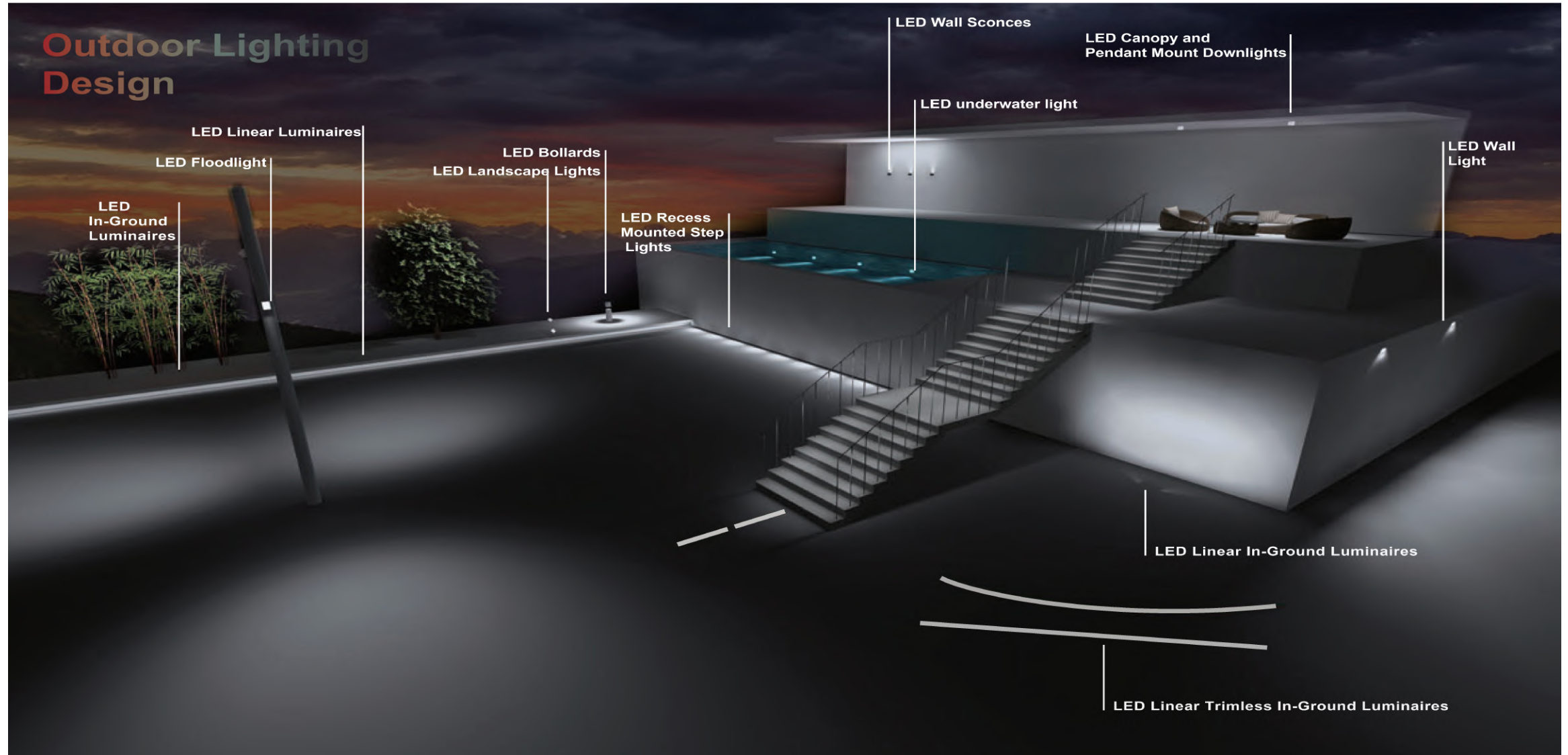



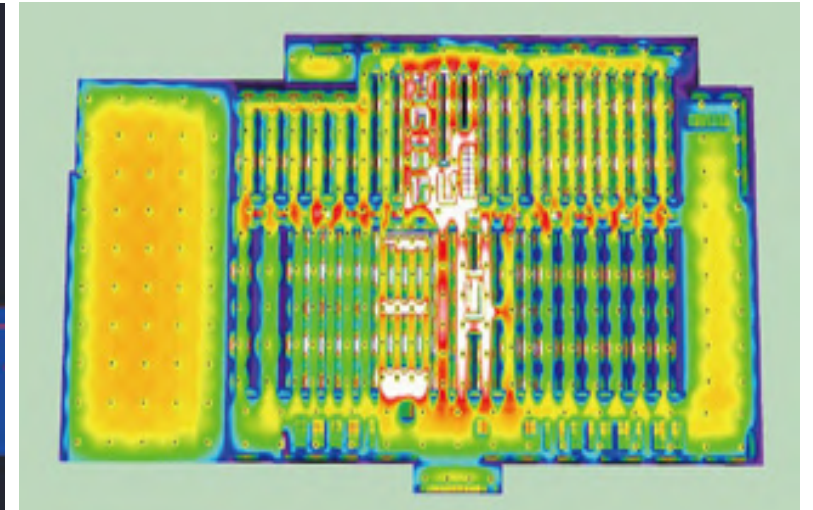
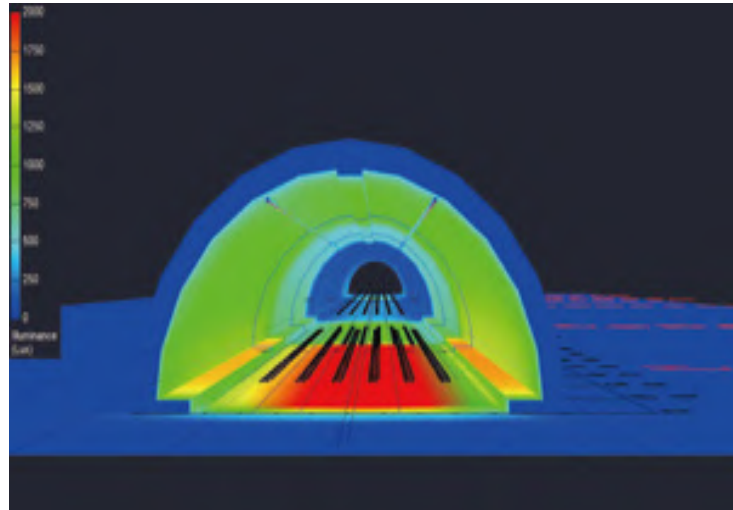
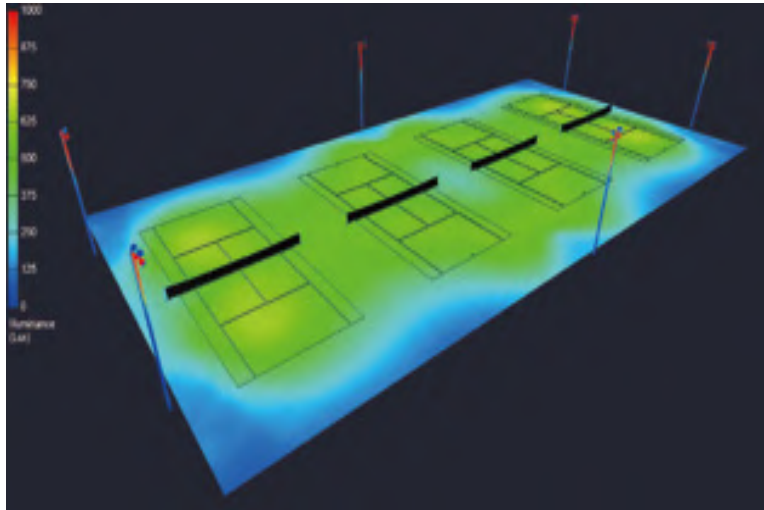





**INNOVATION**



**OPTICAL R&D**



**H&E LIGHTING**



**FAITH**

**RIZO**



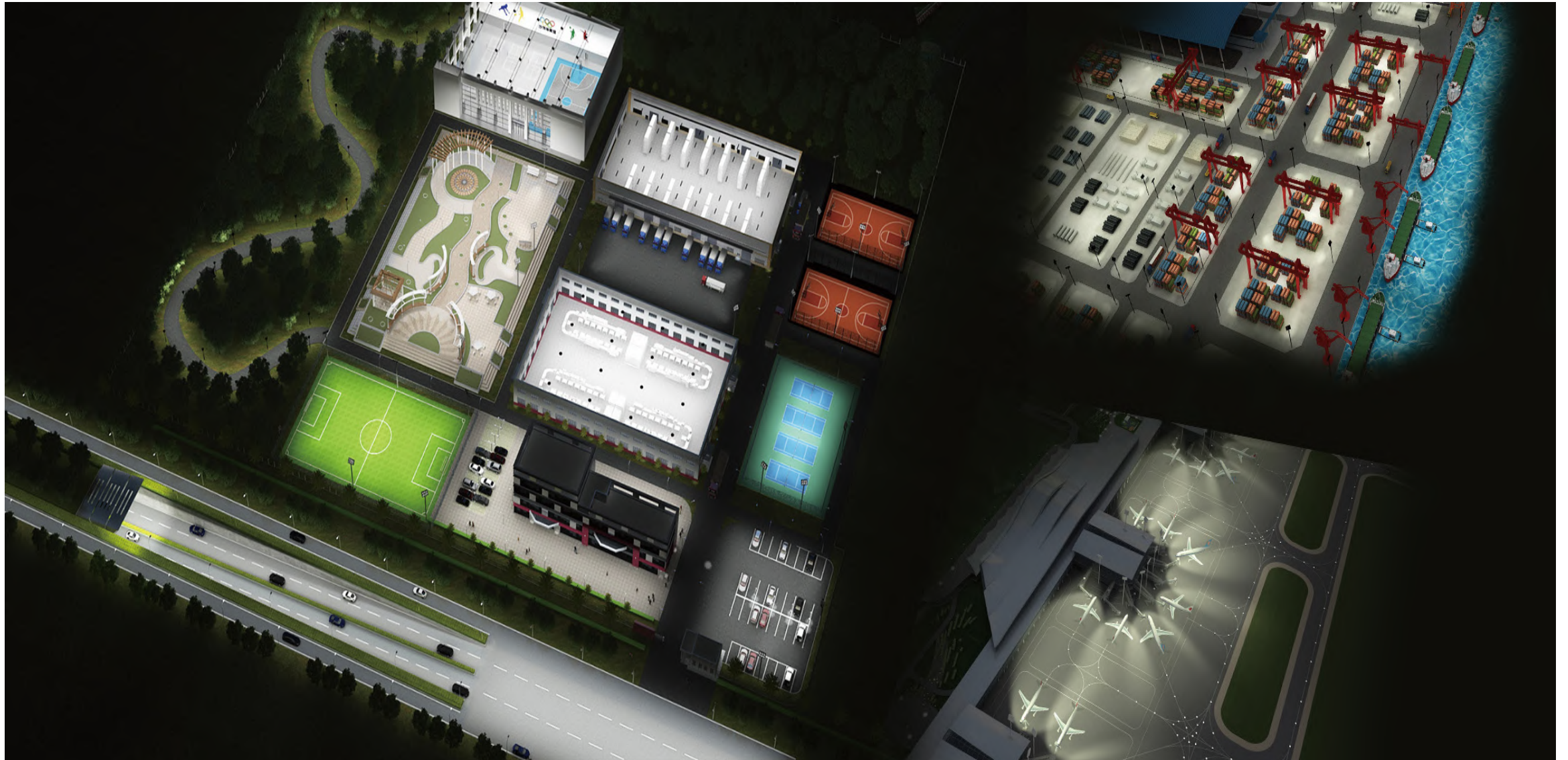





## The East China Sea Fleet

The main lighting of the guidance department of the East China Sea Fleet adopts the engineering lighting products (including DALI dimmable downlights) provided by our. The project product testing process is strict, and the lighting requirements are extremely high. Sande's products have passed all the high standard tests conducted by the East China Sea Fleet in Beijing once and for all, it shows that our lamps are of high quality and meet all the requirements under the extremely strict environment.



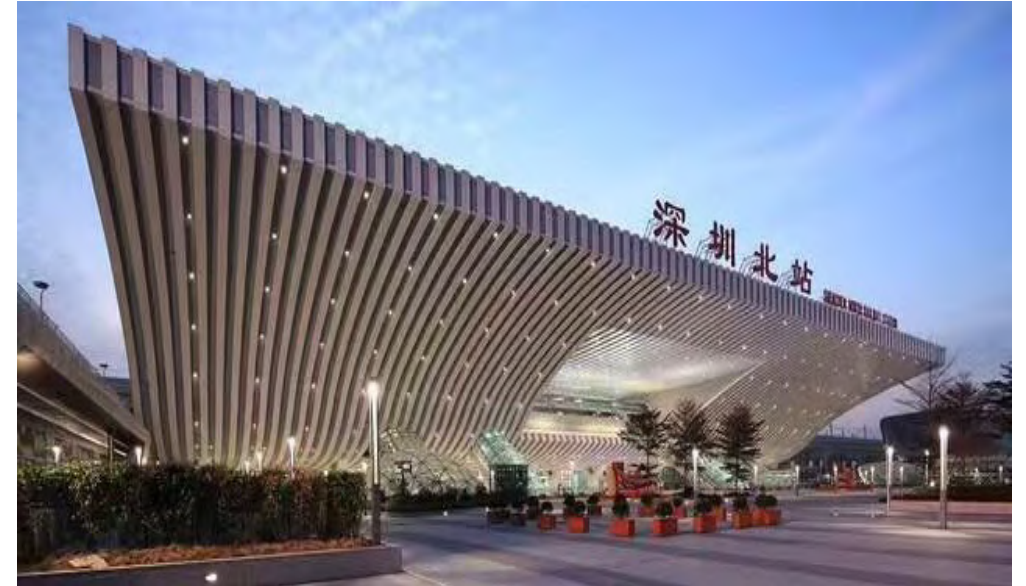

## Shenzhen North Railway station

Shenzhen North Railway Station adopts the engineering lighting products provided by our (including DALI dimmable intelligent industrial and mining lamps, LED three proof lamps, integrated explosion-proof projection lamps, square lighting lamps and other high-quality lamps). Every detail shows the high quality and excellent service of our.







## DONGE EJIAO Experience Hotel

The design of Donge Ejiao Health Hotel is based on the design concept of inheriting the essence of Donge's millennium culture, refining traditional cultural elements into modern landscape, high lighting Donge's cultural heritage and aesthetics, and creating a boutique hotel landscape space that combines nature and culture. Use the products ultra soft light series, and tailors a professional intelligent lighting design scheme to bring ultimate optical enjoyment.







## HEBEI Hotel

Hebei Hotel is an international standard hotel for the reception of heads of state. It is the main reception place for various important domestic and foreign affairs activities in Hebei Province. Located in the high-grade residential area of Shijiazhuang, there is a provincial museum near the hotel. It was rated as the best star hotel in China in 1994. In 1995, it was ranked among the top 50 star hotels in China. It is a five-star multi-functional hotel, integrating accommodation, catering, entertainment and leisure, with a total floor area of 55,000 square meters, 329 guest rooms, a trendy recreation center, a 1,200 square meter pillarless multi-function banquet hall, a luxury thermostatic swimming pool, and one-stop wedding services. In this project, lighting design and intelligent dimming products are provided by our, making every effort to realize more possibilities for its diversified scene transformation.







## Jiuxianshan Hotel

We cooperates with East Lake Hotel Group to provide products and services for Yangchun East Lake International Hotel. It adheres to the craftsmanship spirit of "smart and soft light", insight into the smallest details in demand, control each process of the product, create arelaxed atmosphere with exquisite and comfortable light environment and meticulous services, andcreate a comfortable stay experience for customers to enjoy a happy holiday mood.





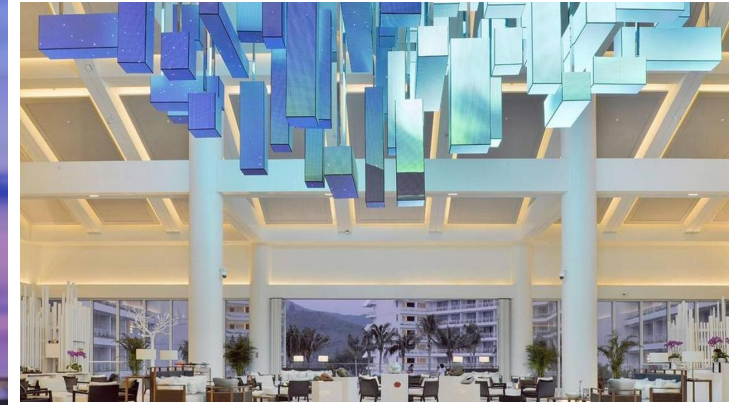

## East Lake International Hotel

East Lake International Hotel has 583 room and comfortable rooms and suites, as well as various suites and townhouses. The overall guest room is mainly designed in a post-modern Chinese style, which is simple and comfortable, elegant in style. The ingenious use of Chinese and Western elements highlights the natural concept of living room culture. The meticulous and comprehensive service, as well as the beautiful and perfect environment and facilities have won unanimous praise from customers.

Our products used in this case are all customized products of East Lake International Hotel.





## Anhui Tianzhu Howard Johnson Hotel

The hotel is located at the intersection of Yingzhou Road and Huaihe Road, the trunk road of Fucheng, adjacent to the urban area, with broad vision, beautiful environment and convenient transportation. The 27 storey main building (25 storeys high, without 13 and 14 storeys) has become the highest building in Fuyang and the landmark of Fuyang. The hotel is reasonably arranged and luxuriously decorated, consisting of a 23 storey main building, a 4-storey podium building and an underground civil air defense.

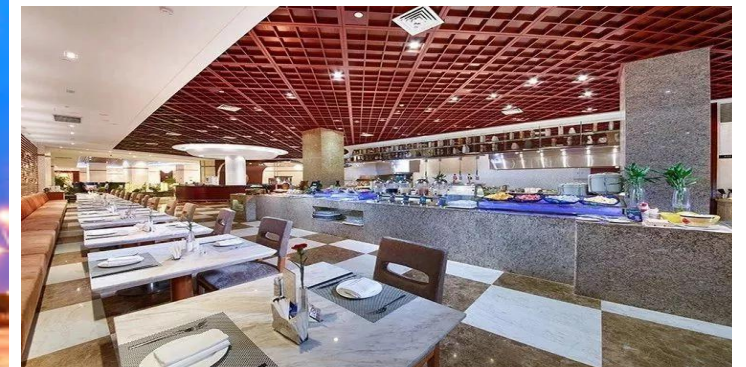





## Reeth Beach Resort in Maldives

We are together with Atmosphere Hotel & Resorts of Maldives, open OBLU by Atmosphereat sangeli, the fourth resort built by Maldives, which is located at St. Geely Beach in the northeast of Male Atoll in Maldives. It's great to spend a holiday on an island in the future. Male International Airport (taking a 50 minute yacht), Aojing and Aolu sister islands connecting the yacht, only 20 minutes. It's also a one price all inclusive resort hotel, with 137 villas, 69 beach villas and 68 water villas. According to its climate characteristics, Sandel has customized suitable lamps professionally.







## Hilton Kuala Lumpur in Malaysia

Hilton Doubletree Kuala Lumpur Hotel is located in the center of Kuala Lumpur, less than 5 minute drive from the twin towers of the National Petroleum Corporation and the Suliya shopping center. This five-star hotel is 4.3 miles from Independence Square and 4.6 miles from the Malaysian Parliament Building. There are 540 air-conditioned rooms with MP3 bases and mini bars.

Hilton Hotel Kuala Lumpur, Malaysia is one of the many hotel projects in Malaysia. It took 24 months from the initial lighting design, selection, lighting test and final finalization. We uses the design concept of light and shadow to blend the light with the environment and create a mutual reflection of light and scenery. The lamp is with the environment around, reflecting the environment more real, natural and Fun. It reflects the product concept of our "Lighting Technology for The Future".



## PROJECT WE DONE

---

**RIZO**







## Dubai International Airport

Dubai International Airport is the main airport in Dubai of United Arab Emirates, is also the hub of Emirates Airlines, which can take off and land all aircraft types. It is the largest airport in the Middle East. Nearly 300 Dubai flights fly to all parts of the world every day. We provide a series of professional lighting fixtures for its Lighting improvement project.





## HA NOI CHILDREN PARK

Hanoi Children's Palace is built on an area of nearly 40,000m<sup>2</sup> in the capital Hanoi, Vietnam. This will be a place for children to relax and explore their passion for art and sports. Hanoi Children's Palace is designed with the theme "Nurturing and Developing" with two large buildings. Area A includes a complex of 800-seat multi-purpose theater, cinema, art clubs. Area B includes a gymnasium, 10-lane swimming pool, a system of modern classrooms, libraries and offices. The 18-storey Astronomical Tower, 68m high, is shaped like a large torch. We are proud to provide lighting products for the project.

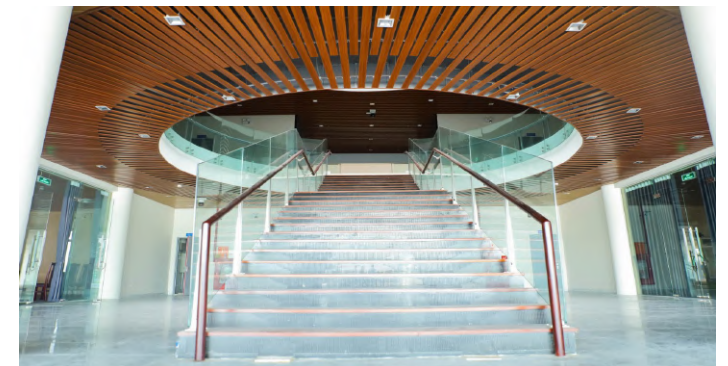





**Sichuan Fine Arts Institute**





Sichuan Fine Arts Institute





**Shanghai Grand Gateway**







Shanghai Disneyland



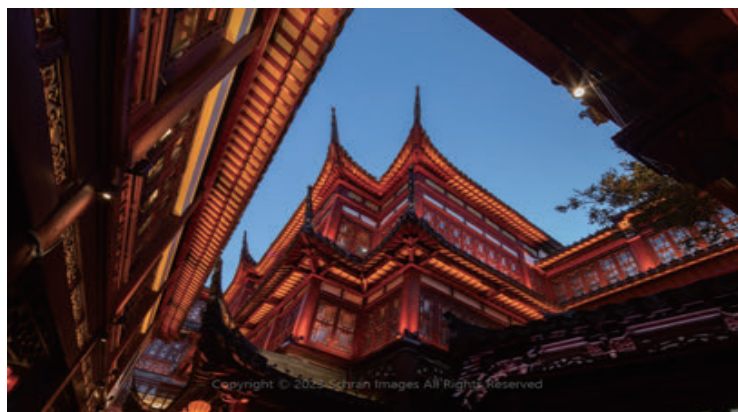

Shanghai Yu Garden







**Shanghai Disneyland**









**Transport infrastructure**

















**THANK YOU**