

RZ0167IGB

Inground Light Stainless Steel 316 Cover, Anti-Corrosion, Transparent Toughened Glass Led 0.5W 40lm CRI80 24VDC D30mm 50.000h IP67

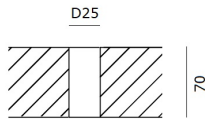
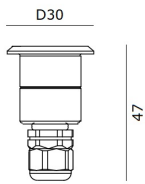

Description

Recessed luminaire that can be installed in concrete floors or in the ground. It is designed to use white monochrome LED lamps, for lighting, fixed optic.

Housing: Die-casting Aluminum with Stainless Steel 316 Cover, Anti-Corrosion, No-Rinse surface treatment. Surface with electrostatic plastic coating and Optimised for reduced accumulation of dirt, with a high level of weather resistance. Stainless steel fasteners in grade 316, Durable silicone rubber gasket.

Luminaire head with transparent toughened non-reflective glass, resist the impact and friction.

Control gear: Longitudinally watertight cable, 1 cable entries. 2-pole terminal block. Installation with separate connection sleeve.

LED module: High-power LEDs on metal-core PCB. Collimating lens made of optical Polymethyl. Tender and soft light to perfectly present the object without black spot and dark area.

Dimming driver can be optionally sold separately: Dali, 0-10V, Triac, Wireless.

Protection mode IP67: dust-proof and accidental immersion up to 1m deep.

Suitable for walk-over with a maximum static load resistance of 300kg.

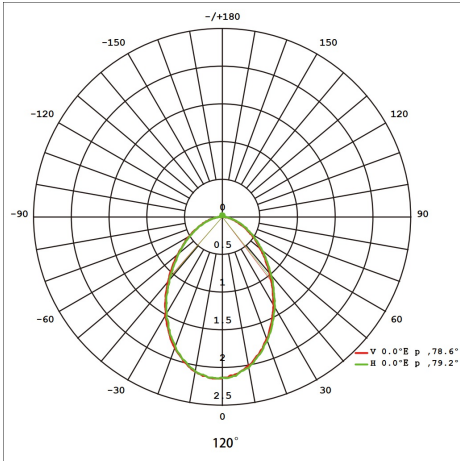

Technical data

Light source	LED COB
System Wattage	0.5W
Luminous flux	40lm
Number of led lamp	1 Led
Luminous efficiency	80lm/w or option
Colour Temperature	2700K, 3000K, 4000K, 6000K
Colour Rendering Index	CRI>80, [CRI>90]
Colour Deviation	SDCM<3
Beam Angle	120°
Rotation Angle	-
Anti-glare Rating	-
Service Lifetime	50.000 Hrs L80 B20 Ta35
Ingress Protection	IP67
Operation Voltage	24VDC
Operation Temperature	-30°C ~ 50°C
Frame	Aluminum & Stainless Steel 316 Cover
Finishing	Non-Color
Lighting control (option)	Dali, 0-10V, Triac, Wireless

Accessories

-

Notes

-

